

=-°) V

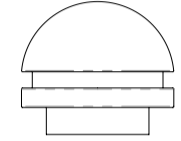

=-°) V

Ô[[~' i- Áá @• Á @, } Áe^Á áææ^Á } | Áe áÁ æ Áá-Á Á Áæ É

SPECIFICATIONS

Code	BOL0219 - S/S Body with Cast Head BOL0218 - Mild Steel Body with Cast Head
Material	304 Stainless Steel or Mild Steel Galvanised
Height	900mm Above Ground
Diameter	Ø114.3 x 3.05 Wall Pipe - Stainless Steel Ø114.3 x 4.5 Wall Pipe - Mild Steel
Weight	12 Kg
Mounting	Bolt Down with 3 x M12 Dynabolts or Similar

FEATURES

- 304 grade stainless steel electropolished with powdercoated cast head
- Mild steel hot dip galv & powdercoated with powdercoated cast head
- Cast aluminium head in range of designs - powdercoated finish

• Bollards are not supplied with installation instructions, install fastenings or footing details. These are to be specified and determined by the installing contractor for the specific requirements of each site.