

Ô[[~ | • Áã @ • Á @ , } Áã Áã áãã Á } | Áã áÁ æ Áã-! Á Áãã È

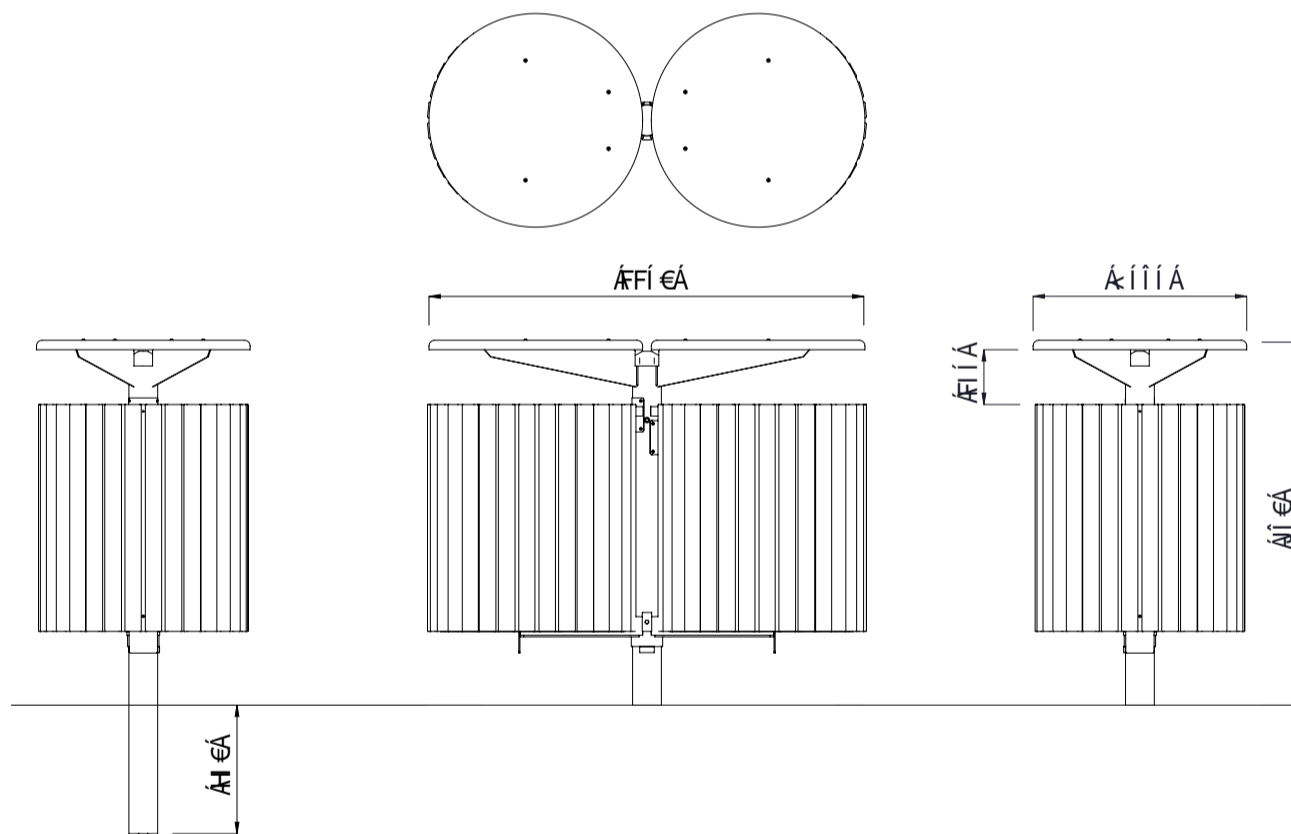

MATERIALS

- Timber (Hardwood)**
 - Vitex as standard
 - Other species available on request
- Steelwork**
 - Mild steel
 - Galvanised liners as standard - 100L
- Hardware / Fasteners**
 - Stainless steel

FINISHES

- Un-sealed (Natural) as standard
- Hot dip galvanised and **powdercoated**

FINISH OPTIONS

- Penetrating oil / Graffiti guard / Clear sealant
- Custom paint options

OPTIONS

- Plant mounted as standard
- Single or Double units

DIMENSIONS

- Ø455 x 960H x 1150W

WEIGHT

- 88Kg

- Part of the 'Tilt Bin' range. Made to order and can be customised to suit clients requirements.
- Furniture is not supplied with installation instructions, install fastenings or footing details. These are to be specified and determined by the installing contractor for the specific requirements of each site.



Ūi   !  ŪF  VĂoăĂ   ăoVă  !  Ū| 



Ūi   !  ŪF  VĂoăĂ   ăoVă  !  Ū| 



Ūi   !  ŪF  Ō[   !  VĂoăĂ   ăoVă  !  Ū| 



Ūi   !  ŪF  Ō[   !  VĂoăĂ   ăoVă  !  Ū| 



VăcĂoăĂ {    ĂĂ  SĂ! {  Ă! {  [ Q&  !  !D



VăcĂoăĂ {    ĂĂ  SĂ! {  Ă! {  [ Q&  !  !D